

10 = Gear Box  
Iselta Export 57

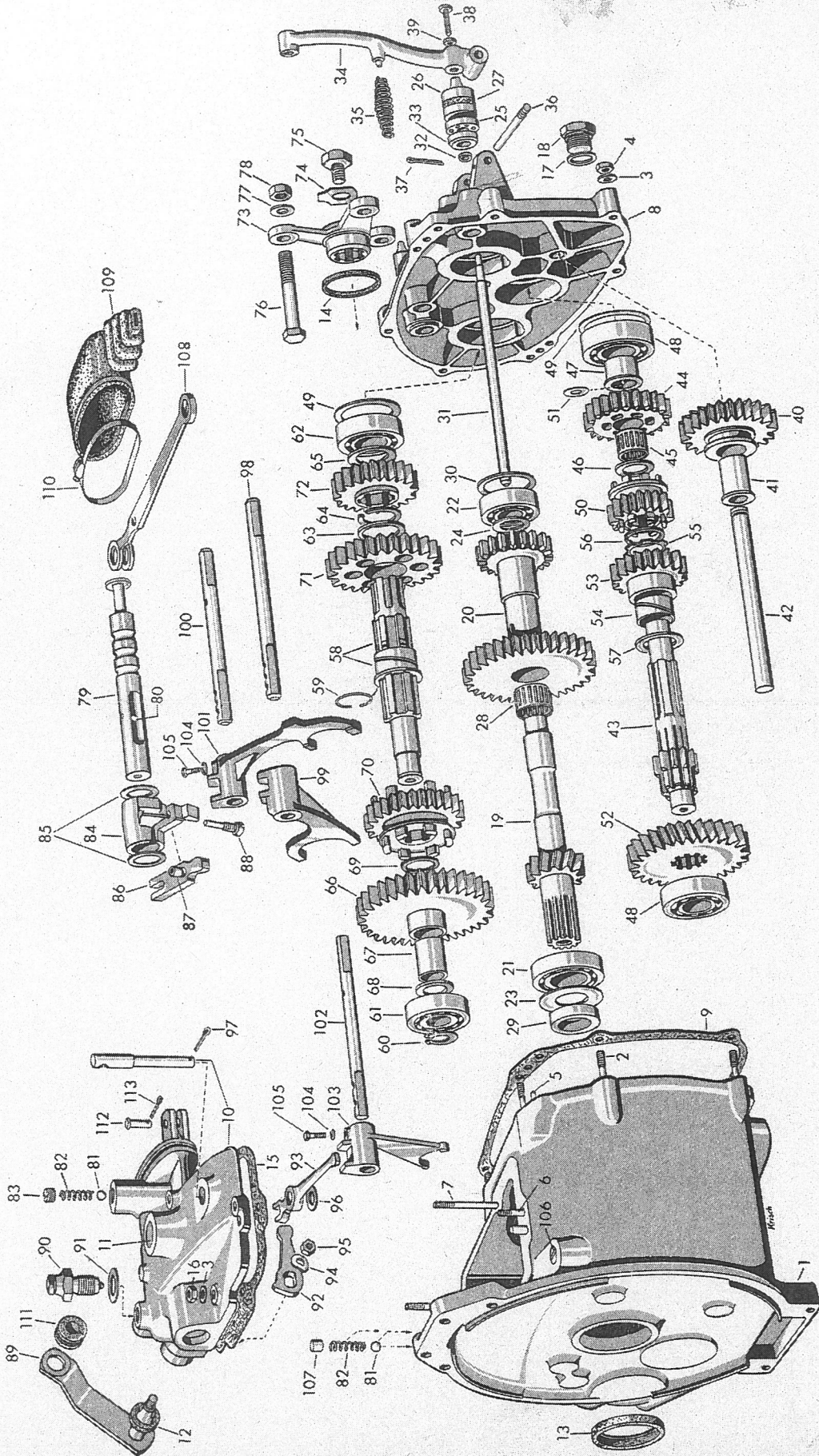

10 = Gear Box

Plate 2

Part No.	Key No.	Description	Qty.
<b>Gear box</b>			
10 00 050	—	4-speed gear box	1
<b>Gear box housing</b>			
10 06 052	1	gear box housing with cover and studs	1
10 06 060	—	gear box housing with studs	1
99 03 220	2	stud M 6×25 Sn 4—5 S pho. (E) for gear box housing cover	5
99 03 222	—	stud M 6×28 Sn 4—5 S pho. (E) for gear box housing cover	2
99 31 046	3	washer 6,5 pho.black.	7
99 22 054	4	hex. nut M 6—6 S pho.black.	7
99 33 078	—	spring washer B 6 (for 300 c.c.)	2
10 12 100	5	fitting pin for gear box housing cover	2
99 03 195	6	stud M 6×18 Sn 4—5 S pho. (E) for gear change cover	2
99 03 252	7	stud M 6×45 Sn 4—5 S pho. (E) for gear change cover	1
99 03 260	—	stud M 6×50 Sn - 4 pho. (E) gear change cover	1
10 12 058	8	gear box housing cover	1
10 12 502	9	gasket between gear box housing and cover	1
10 12 055	10	gear change cover	1
99 37 270	11	plug for gear change cover	2
10 12 505	12	felt washer for gear change lever on cover	1
10 20 500	13	seal ring for driving shaft to housing	1
10 30 540	14	seal ring for output shaft to housing	1
For gear change cover to gear box housing:			
10 12 506	15	gasket	1
99 31 046	3	washer 6,4 pho.black.	4
99 22 054	16	hex. nut M 6—6 S pho.black.	4
99 33 078	—	spring washer B 6	4

10 = Gear Box / Reverse gear / Lay shaft		Plate 2	
Part No.	Key No.	Description	Qty.
<b>Reverse gear</b>			
10 50 051	40	sliding gear with bushing	1
10 50 501	41	bushing for sliding gear	1
10 50 505	42	shaft for reverse gear	1
<b>Lay shaft</b>			
Rear lay shaft bearing with bushing and washer			
10 40 053	43	lay shaft	1
10 40 516	44	4th speed gear wheel	1
10 40 519	45	needle cage for 4th speed gear wheel	1
10 40 520	46	washer for bushing	1
10 40 522	47	bushing	1
99 81 416	48	ball bearing 6303 C3, front and rear	2
10 30 116	49	shim for rear ball bearing (width as required)	1
10 40 547	50	sliding dog gear, 3rd and 4th speed	1
10 40 550	51	shim for lay shaft, rear	1
10 40 540	—	washer for lay shaft (necessary on 250 c. c. up to chassis No. 434 307, on 300 c. c. up to chassis No. 507 320)	1
For lay shaft, front:			
10 40 526	52	gear for lay shaft	1
10 40 532	53	3rd speed gear	1
10 40 534	54	bushing for 3rd speed gear for part No. 10 40 531	1
10 40 533	54	bushing for 3rd speed gear for part No. 10 40 532	1
10 40 539	55	washer for lay shaft part No. 10 40 531	1
10 40 540	55	washer for lay shaft part No. 10 40 532	1
10 40 542	56	snap ring	1
10 40 104	57	thrust washer	1

10 = Gear Box / Driving shaft		Plate 2	
Part No.	Key No.	Description	Qty.
For oil filler and oil outlet of gear box housing:			
99 63 242	17	seal ring C14X20 steel-asbestos	2
00 07 104	18	drain plug M14	2
00 07 106	18	drain plug with larger thread (by 0,1 mm)	as req.
00 07 108	18	drain plug M16 (replacement for part No. 00 07 106 in case thread is torn off)	as req.
99 63 259	17	seal ring C16X20 steel-asbestos (for drain plug part No. 00 07 108)	as req.
<b>Driving shaft</b>			
10 20 050	19	driving shaft	1
10 20 060	20	intermediate shaft	1
99 81 226	21	ball bearing 6205 C3, front	1
99 81 214	22	ball bearing 6203 C3, rear	1
10 20 100	23	washer for driving shaft, front	1
10 20 102	24	washer between driving and intermediate shaft	1
10 20 104	25	ball cage	1
10 20 526	26	thrust piece	1
10 20 108	27	seal ring	1
10 20 504	28	needle cage for intermediate shaft front and rear	2
10 20 506	29	ball race for driving shaft, front	1
10 20 508	30	shim for driving shaft, rear	1
10 20 510	31	thrust rod	1
10 20 512	32	seal ring	1
10 20 514	33	thrust washer	1
10 20 519	34	clutch release lever	1
10 20 523	35	cap spring for clutch release lever	1
For clutch release lever to gear box housing cover:			
10 20 112	36	clutch release lever bolt	1
99 45 180	37	split pin 3X28 st. cad.	1
10 80 513	38	adjusting screw for clutch release lever	1
99 21 055	39	hex. nut BM 6—5 pho.black. for clutch release lever	1

10 = Gear Box / Gear changing mechanism			Plate 2
Part No.	Key No.	Description	Qty.
		Selector ratchet in gear box cover for gear change lever shaft:	
99 86 275	81	ball 7,5 mm for ratchet .....	1
10 66 500	82	pressure spring for ball .....	1
10 66 507	83	plug .....	1
10 66 510	84	gear changing segment .....	1
—	85	deleted .....	—
10 66 512	86	selector fork .....	1
10 66 516	87	distance bush for selector fork .....	1
10 66 520	88	pin screw for gear changing segment .....	1
10 66 527	89	regulating lever with bolt for level of gear changing mechanism (for 250 c.c.) .....	1
10 66 592	—	bushing for regulating lever (for 250 c.c.) .....	1
10 66 571	90	stop for reverse gear .....	1
10 66 566	—	retain pin for stop .....	1
20 60 269	91	washer for stop to gear change cover .....	1
10 66 533	92	gear lever for gear changing segment on regulating lever .....	1
10 66 536	93	carrier lever for reverse gear .....	1
		For gear lever on regulating lever:	
99 32 091	94	spring washer B 8 .....	1
99 21 606	95	hex nut M8X1—6S .....	1
		For carrier lever to bolt of gear change cover:	
99 31 672	96	washer .....	1
99 45 165	97	split pin .....	1
		Selector fork guides:	
10 66 540	98	selector fork guide for 1st and 2nd speed .....	1
10 66 545	99	selector fork for 1st and 2nd speed .....	1
10 66 549	100	selector fork guide for 3rd and 4th speed .....	1
10 66 552	101	selector fork .....	1
10 66 557	102	selector fork guide for reverse gear .....	1
10 66 560	103	selector fork .....	1

10 = Gear Box / Output shaft / Gear changing mechanism			Plate 2
Part No.	Key No.	Description	Qty.
		<b>Output shaft</b>	
10 30 050	58	output shaft with bushing and snap ring .....	1
10 30 100	59	snap ring .....	1
99 34 071	60	snap ring 14X1 .....	1
99 81 408	61	ball bearing 6302 C3, front .....	1
99 81 219	62	ball bearing 6204 C3, rear .....	1
10 30 104	63	thrust washer for 2nd speed gear .....	1
10 30 108	64	snap ring for 2nd speed gear .....	1
10 30 112	65	thrust washer for 4th speed gear .....	1
10 30 116	49	shim for ball bearing, rear (thickness as required) .....	1
10 30 502	66	1st speed spur gear with bushing .....	1
10 30 505	67	bushing for 1st speed spur gear .....	1
10 30 508	68	thrust washer, front .....	1
10 30 512	69	thrust washer, rear .....	1
10 30 517	70	sliding dog gear, 1st and 2nd speed, for selector fork .....	1
10 30 520	71	2nd speed gear .....	1
10 30 524	72	4th speed gear on output shaft .....	1
		Coupling flange:	
10 30 528	73	coupling flange on output shaft .....	1
99 35 048	74	lock plate 10,5 st. pho.black. ....	1
10 30 536	75	hex. screw .....	1
10 30 532	76	hex. screw .....	3
99 31 665	77	washer 10,5 pho.black. ....	3
99 22 111	78	hex. screw M 10—6 S pho.black. ....	3
		<b>Gear changing mechanism</b>	
10 66 050	79	gear change shaft with stud .....	1
99 42 091	80	stud 6 m 6X16 .....	1

10 = Gear Box / Gear changing mechanism

Plate 2

Part No.	Key No.	Description	Qty
		For selector fork to guide:	
99 33 058	104	spring washer B 5 .....	3
10 66 564	105	screw .....	3
		Ratchet for selector fork guide in gear box housing:	
99 86 275	81	ball .....	3
10 66 500	82	pressure spring .....	1
10 66 504	106	plug .....	1
10 66 586	107	filler .....	1
		Gear change lever:	
10 66 568	108	gear change lever (for 250 c.c.) .....	1
10 66 572	109	rubber boot .....	1
10 66 576	110	hose clamp for rubber sleeve .....	1
10 66 592	(111)	bushing for gear change and regulating lever .....	2
		For gear change lever to gear change cover:	
99 40 418	112	pin 8h X 11 X 25 X 22 pho.black. ....	1
99 45 095	113	split pin 2 X 15 st. ....	1