

40 = Chassis Group

Isetta Export 57

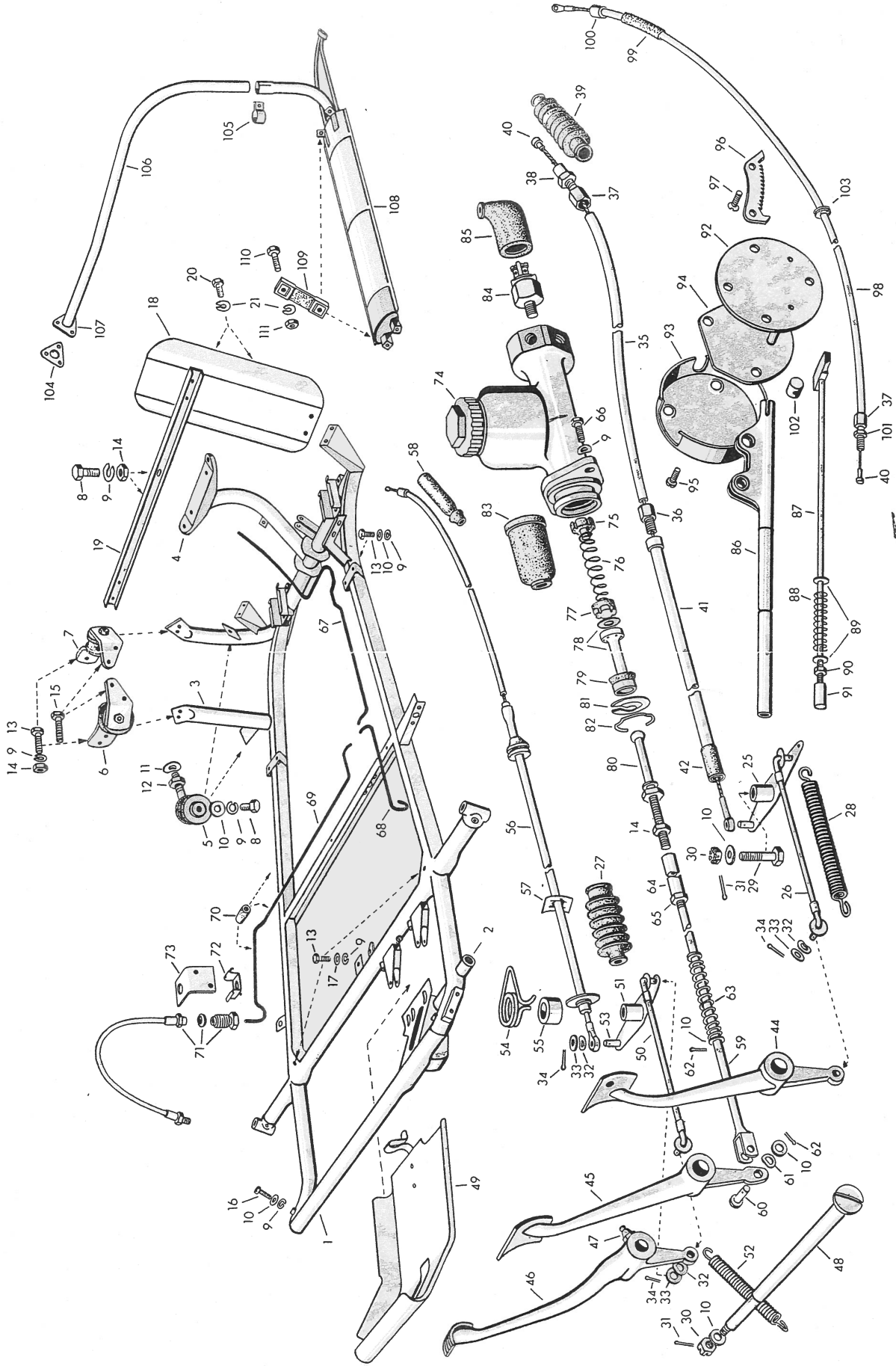

40 = Chassis / Frame

Plate 5

Part No.	Key No.	Description	Qty.
Frame			
40 00 057	7	frame, compl. for production model and convertible	1
40 00 060	—	frame, compl. for pick-up Isetta	1
40 00 570	2	bushing for steering shaft	2
99 63 030	—	seal A 6X10 al.	1
99 60 606	—	grease nipple, D 6 galv.	1
40 00 534	3	engine support	1
40 00 542	4	shock absorber support for production model and convertible	1
40 00 541	—	shock absorber support or pick-up Isetta	1
40 00 594	—	reinforcement plate for shock absorber support No. 40 00 542	2
40 00 597	—	reinforcement plate for shock absorber support No. 40 00 541	2
40 34 501	5	lower elastic mounting, compl.	2
40 34 505	—	lower elastic mounting	2
40 34 523	6	upper elastic mounting, front, compl.	1
40 34 533	7	upper elastic mounting, rear, compl.	1
40 34 527	—	upper elastic mounting, front and rear	2
For the upper and lower elastic mountings, front and rear:			
99 33 087	—	spring washer A 8 for the upper elastic mountings, front and rear	4
99 32 080	—	spring washer A 8 for lower elastic mounting	2
99 22 082	—	hex. nut M 8—6 S pho.black.	6
For fastening the elastic mountings to frame, below:			
99 13 621	8	hex. screw M 8X15—8 G pho.black.	2
99 33 087	9	spring washer A 8	2
99 31 066	10	washer 8,4 pho.black. (use only for front mounting, below)	1

40 = Chassis / Frame		Plate 5	
Part No.	Key No.	Description	Qty.
20 72 149	17	Fastening parts body — 2nd cross member, left, center, right:	
		washer	3
99 13 650	13	hex. screw M 8×22—8 G pho.black.	3
99 33 087	9	spring washer A 8	3
99 31 066	10	Fastening parts body — rear side member plates:	
		washer 8,4 pho.black.	4
99 13 650	13	hex. screw M 8×22—8 G pho.black.	4
99 33 087	9	spring washer A 8	4
40 34 578	—	Fastening parts right body side panel — rear supporting bracket of frame:	
		washer	2
99 13 457	—	hex. screw M 6×15—8 G pho.black.	2
99 33 070	—	spring washer A 6	2
99 22 054	—	hex. nut M 6—6 S pho.black.	2
		Support for license plate to rear portion of body and for front license plate to the door (USA model refer to page 62)	
		For support to rear portion, above and below:	
		hex. screw M 6×10—8 G pho.black.	2
		spring washer B 6	2
		hex. nut M 6—6 S pho.black.	2
99 13 210	—	For license plate to rear support, above and below:	
		hex. screw M 5×8—8 G pho.black.	3
99 32 045	—	spring washer B 5	3
99 22 036	—	hex. nut M 5—6 S pho.black.	3

40 = Chassis / Frame		Plate 5	
Part No.	Key No.	Description	Qty.
		For fastening the elastic mountings to lower part of engine housing:	
99 32 160	11	spring washer B 16	2
99 21 636	12	hex. nut M 16×1,5—6 S pho.black.	2
99 13 650	13	For the upper elastic mounting to frame, front and rear:	
		hex. screw. M 8×22—8 G pho.black.	4
99 33 087	9	spring washer A 8	4
99 22 082	14	hex. nut M 8—6 S pho.black.	4
		For the upper elastic mounting to engine:	
99 12 455	15	hex. screw. M 8×30—8 G pho.black.	2
99 22 082	14	hex. nut M 8—6 S pho.black.	4
99 33 087	9	spring washer A 8	4
40 34 593	—	1 set felt linings between frame and body consisting of: 2 felt strips for left and right side member 1 felt strip for 3rd cross member 2 felt linings for left and right frame plate 1 felt lining for 2nd cross member plate 1 felt lining for bracket of silencer suspension, front left 2 felt linings for front angle bracket plates, left and right 6 felt linings for 1st and 2nd cross member, left and right	
		Screw connection body—frame	
		Fastening parts body — 1st cross member, left and right: sealing (rubber) between door post and front part of frame	1
40 34 570	—	cyl. screw M 8×25—8 G pho.black.	2
99 19 977	16	spring washer A 8	2
99 33 087	9	washer 8,4 pho.black.	2
99 31 066	10		2

40 = Chassis / Mudguards / Clutch operating linkage		Plate 5	
Part No.	Key No.	Description	Qty.
40 38 560	—	valve	5
40 38 551	—	wheel nut	16
40 38 555	—	wheel cap	4
40 39 500	—	balancing weight	as req.
Mudguards			
40 34 541	18	rear mudguard	2
40 34 562	19	rear mudguard support with bracket	1
Fastening parts for rear mudguard to frame bracket, left and right, to mudguard support, left and right, incl. intake silencer, right, furtheron for intake silencer to center of mudguard support:			
99 13 457	20	hex. screw M 6X15—8 G pho.black.	9
99 33 070	21	spring washer A 6	9
For rear mudguard support to shock absorber support:			
99 13 621	8	hex. screw M 8X15—8 G pho.black.	2
99 33 087	9	spring washer A 8	2
99 22 082	14	hex. nut M 8—6 S pho.black.	2
Clutch operating linkage			
40 40 516	25	connector lever	1
40 40 503	26	push rod	1
40 40 572	27	rubber sleeve	1
40 40 513	28	retain spring between steering gear housing support and connector lever	1
For connector lever to 2nd cross member:			
40 40 524	29	hex. screw	1
99 31 066	10	washer 8,4 pho.black.	1
99 23 412	30	castellated nut M 8—6 S pho.black.	1
99 45 105	31	split pin 2X18 st.	1

40 = Chassis / Frame / Wheels		Plate 5	
Part No.	Key No.	Description	Qty.
Fastening parts front license plate — door:			
85 54 112	—	rubber washer	2
99 13 210	—	hex. screw M 5X8—8 G pho.black.	2
99 32 045	—	spring washer B 5	2
Nameplates (USA model refer to page 62)			
40 34 590	—	nameplate BMW Isetta 250 c. c.	1
40 34 591	—	nameplate BMW Isetta 300 c. c.	1
40 34 583	—	nameplate BMW Isetta to be stamped with 250 c. c. or 300 c. c. as required	1
Instruction transfer pictures			
(USA model refer to page 62)			
Transfer picture, German:			
90 90 573	—	for choke and heater	1
90 90 576	—	for fuel tap	1
90 90 580	—	for windscreen	1
90 90 574	—	for gear changing	1
Wheels			
40 38 050	—	disc wheel, compl. with wheel cap support and reinforcement plate	5
99 32 160	—	spring washer B 16	16
40 38 550	—	wheel nut	16
40 38 554	—	wheel cap	4
99 13 620	—	hex. screw M 8X15—8 G pho.black.	30
99 33 087	—	spring washer A 8	30
99 22 081	—	hex. nut M 8—6 S	30
For cars with tubeless tires:			
40 38 051	—	one piece wheel with valve	5

40 = Chassis / Pedal mechanism / Gas operating linkage		Plate 5	
Part No.	Key No.	Description	Qty.
		Pedal mechanism for 250 c. c. from chassis No. 441 650 for 300 c. c. from chassis No. 574 990	
40 40 052	—	clutch pedal	1
40 44 051	—	brake pedal	1
40 42 051	—	accelerator pedal	1
99 60 605	—	grease nipple A 6 for accelerator pedal	1
		For pedal mounting:	
40 42 501	—	pedal shaft	1
10 66 114	—	shim	2
99 34 060	—	lock washer 12X1	2
		Gas operating linkage	
40 42 510	50	accelerator control rod	1
40 42 512	51	connector lever with pin and bushing	1
40 42 524	52	return spring between control rod, accelerator pedal and frame	1
99 40 350	53	pin for connector lever (6 h 11 X 16 X 13,5 st. 42 K)	1
		For control rod to accelerator pedal and for bowden cable to intermediate lever:	
99 32 060	32	spring washer A 6	3
99 31 046	33	washer 6,4 pho.black.	3
99 45 055	34	split pin 1,5X10 (for connector lever)	2
		For connector lever to 2 nd cross member:	
40 40 524	—	hex. screw	1
40 42 514	54	stop spring	1
40 42 518	55	guide bush	1
99 31 066	10	washer 8,4 pho.black.	1
99 23 412	30	castellated nut M 8—6 S pho.black.	1
99 45 105	31	split pin 2X18 st.	1

40 = Chassis / Clutch operating linkage / Pedal mechanism		Plate 5	
Part No.	Key No.	Description	Qty.
		For push rod between clutch pedal and connector lever and for bowden cable to connector lever:	
99 32 060	32	spring washer A 6	3
99 31 046	33	washer 6,4 pho.black.	3
99 45 055	34	split pin 1,5X10 st.	3
		Bowden cable for clutch:	
40 40 531	35	bowden cable	1
40 40 544	36	retainer	1
40 40 558	37	adjusting screw	1
40 40 560	38	adjusting nut	1
40 40 536	—	sleeve	1
40 40 540	39	rubber boot	1
40 40 565	40	nipple	1
40 40 570	41	protective tube with threaded bush	1
80 70 186	42	rubber sleeve	1
		Pedal mechanism for 250 c. c. up to chassis No. 441 649 for 300 c. c. up to chassis No. 574 989	
40 40 051	44	clutch pedal	1
40 44 050	45	brake pedal	1
40 42 050	46	accelerator pedal	1
40 42 051	—	accelerator pedal to shaft 40 42 501	1
99 60 605	47	grease nipple A 6 for accelerator pedal	1
20 71 550	—	sealing base for clutch pedal	1
20 71 553	—	sealing base for accelerator and brake pedal	1
		For pedal bearing:	
40 42 500	48	pedal shaft	1
40 42 501	—	pedal shaft, only for accelerator pedal 40 42 051	1
99 31 066	10	washer 8,4 pho.black.	1
99 23 412	30	castellated nut M 8—6 S pho.black.	1
99 45 105	31	split pin 2X18 st.	1
90 16 551	49	undershield for pedal mechanism and linkage	1
90 16 555	—	tensioning spring	1

40 = Chassis / Brake operating linkage / Brake lines			Plate 5
Part No.	Key No.	Description	Qty.
		For push rod spring:	
40 44 556	63	pressure spring	1
99 31 066	10	washer 8,4 pho.black.	2
99 45 091	62	split pin 2X12 st.	1
		Connection push rod — brake master cylinder:	
40 44 561	64	adjusting nut	1
99 22 082	14	hex. nut M 8—6 S pho.black.	1
99 22 083	65	hex. nut M 8 L.H. thread—6 S pho.black.	1
		For brake master cylinder to 3 rd cross member:	
99 13 643	66	hex. screw M 8X20—8 G pho.black.	2
99 33 087	9	spring washer A 8	2
		Brake lines	
40 50 051	—	brake master cylinder with stop light switch and dust cap (3 connections)	1
40 50 531	67	rear line	1
40 50 500	—	sleeve for brake master cylinder to floorboard	1
40 50 506	68	line, left	1
40 50 518	69	line, right	1
40 50 540	70	sleeve for fixing lines to frame	9
40 50 544	71	brake hose for lines	3
90 23 119	72	supporting spring for brake hose	3
40 50 510	—	bracket, left, on wheel housing	1
40 50 520	73	bracket, right, on wheel housing	1
99 07 103	—	oval head screw M 5X8—5 S cad. for bracket to wheel housing	4
		For brake master cylinder:	
40 50 553	74	cap	1
40 50 556	75	valve	1
40 50 559	76	pressure spring with retainer	1

40 = Chassis / Bowden cable for accelerator / Brake operating linkage			Plate 5
Part No.	Key No.	Description	Qty.
		Bowden cable for accelerator	
40 42 550	—	bowden cable	1
99 88 205	—	wire rope A 1,6X2205 (can only be supplied in metres)	1
99 88 270	—	sleeve for wire rope B 2,5X1645 (can only be supplied in metres)	1
99 88 320	—	terminal bush C 2,5	2
99 88 550	—	nipple for bowden cable, C	1
40 42 517	56	protective tube	1
80 70 106	—	rubber sleeve for 3 rd cross member	1
40 42 534	57	lock plate	1
00 42 111	58	rubber sleeve	1
40 42 533	—	plug	1
80 70 110	—	grommet for bowden cable support of, luggage panel	2
40 40 572	—	rubber sleeve for bowden cable to 2 nd cross member	1
40 42 520	—	cable band (75 mm long, for accelerator and clutch bowden cable support, can only be supplied in metres)	2
		For accelerator bowden cable to connector lever:	
99 32 060	—	spring washer A 6	1
99 31 046	—	washer 6,4 pho.black.	1
99 45 055	—	split pin 1,5X10 st.	1
		Brake operating linkage	
		Push rod, front, to brake pedal:	
40 44 550	59	push rod with fork end (clevis)	1
99 40 254	60	pin 8 f 8X22X17,5 pho.black.	1
99 32 080	61	spring washer A 8	1
99 31 066	10	washer 8,4 pho.black.	1
99 45 091	62	split pin 2X12 st.	1

40 = Chassis / Hand brake / Fuel tank		Plate 5	
Part No.	Key No.	Description	Qty.
Hand brake cable			
40 66 053	98	hand brake cable, compl.	1
40 66 055	—	wire rope with bow	1
40 66 510	99	rubber hose	1
40 66 515	100	sleeve	1
40 40 565	40	nipple	1
40 40 558	37	adjusting screw	1
40 66 522	101	hex. nut for adjusting screw	1
40 66 526	102	pin for hand brake lever	1
40 66 530	103	grommet for rear body panel	1
40 66 130	—	cable band for rear leaf spring, left and right	2
Fuel tank			
40 80 050	—	fuel tank	1
40 80 054	—	filler	1
40 80 535	—	filler cap with BMW emblem	1
40 80 530	—	seal ring for filler cap	1
40 50 500	—	grommet between rear portion and fuel tank filler	1
For fuel tank to luggage panel:			
40 80 538	—	felt strip	2
99 12 281	—	hex. screw M 6×30—8 G pho.black.	2
99 32 071	—	spring washer B 6 pho.black.	2
99 22 054	—	hex. nut M 6—6 S pho.black.	2
Fuel tap with fuel line			
40 84 051	—	fuel tap, compl.	1
40 84 120	—	upper speed nut	1
40 84 530	—	hose nipple	1
40 84 169	—	lower speed nut	1

40 = Chassis / Brake lines / Hand brake		Plate 5	
Part No.	Key No.	Description	Qty.
40 50 562	77	sleeve	1
40 50 565	78	piston with washer	1
40 50 568	79	secondary sleeve	1
40 50 571	80	piston rod, compl. with washer and grooved pin	1
40 50 574	81	retainer	1
40 50 577	82	snap ring	1
40 50 580	83	dust cap	1
80 48 562	84	stop light switch	1
80 48 566	85	dust cap	1
Hand brake at wheel housing			
40 60 530	86	hand brake lever	1
40 60 536	87	push rod for brake lever	1
40 60 542	88	pressure spring	1
99 31 034	89	washer 5,3 pho.black.	2
40 60 546	90	hex. nut	1
40 60 550	91	release button	—
For hand brake lever to left wheel housing:			
40 60 558	92	Support plate, complete	1
40 60 554	93	cover	1
40 60 562	94	anchor plate	1
99 07 108	95	oval head screw M 5×10—5 S cad.	3
Ratchet at support plate:			
40 60 521	96	ratchet	1
99 00 064	97	countersunk screw M 5×8—5 S pho.black.	2
For support plate:			
99 33 058	—	spring washer B 5	3
99 13 227	—	hex. screw M 5×12—8 G pho.black.	2
99 13 235	—	hex. screw M 5×15—8 G pho.black.	1
99 00 067	—	countersunk screw M 5×10—5 S pho.black. (below)	1

40 = Chassis / Exhaust system / Exhaust heater			Plate 5
Part No.	Key No.	Description	Qty.
		Exhaust system with heater (not for tropic models)	
40 90 514	—	exhaust tube with heater	1
40 90 560	—	flange for exhaust tube	1
40 90 592	—	heater control flap	1
40 90 589	—	spring for heater flap control	1
		For support of control flap cable:	
45 74 006	—	clamp	1
99 13 221	—	hex. screw M 5×10—8 G pho.black.	1
99 33 051	—	spring washer A 5	1
		Exhaust heater	
40 90 500	—	exhaust heater, compl.	1
40 90 565	—	heating jet with rubber support	1
40 90 571	—	rubber support for heating control flap	1
		Silencer for exhaust heater:	
40 90 568	—	silencer for exhaust heater	1
40 90 577	—	hose between heating jet and silencer	1
40 90 580	—	hose between silencer and exhaust tube jacket	1
20 00 173	—	clamp for hose	2
		For silencer to rear wall of body:	
40 90 574	—	seal	1
99 32 071	—	spring washer B 6	2
99 19 471	—	cylinder stud AM 6×18—5 S pho.black.	2
		For engine air duct — exhaust tube jacket connection:	
40 90 583	—	sleeve	1
90 32 515	—	clamp	2

40 = Chassis / Fuel tank / Exhaust system			Plate 5
Part No.	Key No.	Description	Qty.
40 84 109	—	seal (fibre)	1
40 84 534	—	cork ring	1
40 84 110	—	seal ring, unfastened	1
		Remote control for fuel tap:	
40 84 512	—	rod for remote control	1
40 84 522	—	lock clamp	1
40 84 520	—	rubber grommet for rod in rear wall	1
40 84 540	—	protective sleeve for rod	1
		Fuel line:	
99 88 860	—	from fuel tap to carburettor (550 mm long), can only be supplied in metres	—
		Exhaust system	
40 90 522	104	gasket for exhaust tube to cylinder head	1
		For exhaust tube to silencer:	
40 90 526	105	clamp	1
99 13 471	—	hex. screw M 6×18—8 G pho.black.	1
99 33 070	—	spring washer A 6	1
99 22 054	—	hex. nut M 6—6 S pho.black.	1
40 90 053	108	silencer (for 250 and 300 c.c.)	1
		For suspension of silencer to frame, front and rear:	
40 90 552	109	rubber strip	4
99 12 240	110	hex. screw M 6×20—8 G pho.black.	8
99 33 070	21	spring washer A 6	8
99 22 054	111	hex. nut M 6—6 S pho.black.	8

Part No.	Key No.	Description	Qty
40 90 586	—	Bowden cable from heating control flap of exhaust tube to control lever:	1
20 88 552	—	bowden cable, compl. grommet for rear wall	1

U S - M O D E L

The list "US-Model" deals with the parts which differ from those of the "Production-Model". Parts, which are identical with those of the "Production-Model", are contained in the list covering the "Production-Model" (black print).

40 = Chassis Group / US model

Part No.	Description	Qty.
	US model:	
	Support for rear license plate	
40 34 597	support at lower rear portion of body	1
99 13 425	hex. screw M 6X10—8 G pho.black.	2
99 13 071	spring washer B 6	2
99 22 054	hex. screw M 6—6 S pho.black.	2
	Nameplates	
40 34 582	nameplate for 300 c. c.	1
40 34 583	nameplate for 250 c. c.	1
	Transfer pictures (English)	
90 90 571	for starter without heater	1
90 90 577	for starter and heater	1
90 90 578	for fuel tap	1
90 90 579	for windshield	1

TROPICAL MODEL

The list "Tropical Model" deals with the parts which differ from those of the "Production-Model". Parts, which are identical with those of the "Production-Model", are contained in the list covering the "Production-Model" (black print)

Unless other indications are given, the quantity numbers apply to the "Production-Model" with rear window, left-hand and right-hand drive, and to the convertible (convertible hood), left hand and right hand drive.

Part No.	Key No.	Description	Qty.
4090512	106	E exhaust system	1
4090560	107	exhaust system upper exhaust tube	1